

Welcome to the Jackson County, NC Real Property Viewer.

Below are some tips for using this site.

For questions about using this site, contact GIS at 828-631-2112 or Land Records at 828-586-7539.

For questions about parcels, contact Land Records.

## **Search**

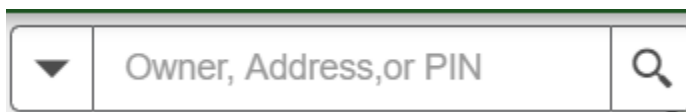
A search bar with a dropdown arrow on the left, the text "Owner, Address, or PIN" in the center, and a magnifying glass icon on the right.

The search bar allows the user to type in either the Owner, Address or PIN (Property Identification Number) to locate a specific property. When performing a search for an owner, type in the owners last name, a comma, a space, then the owners first name. When a search is complete, or the user clicks on a property, a Popup Panel will appear on the left side of the screen. This Popup contains property information including a link to a Property Report and a link to the Property Record Card for that specific property.

## **Search by Road Name**

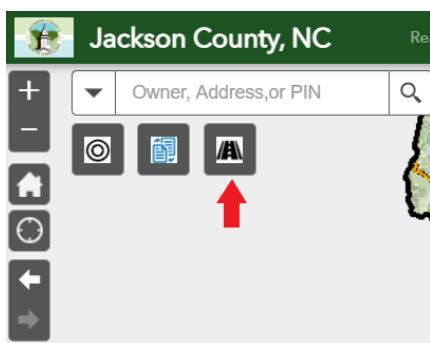

The Search by Road Name tool allows the user the ability to enter a road name to search the map. This is useful when the user does not know a specific address.

## Buffer Selected Parcels

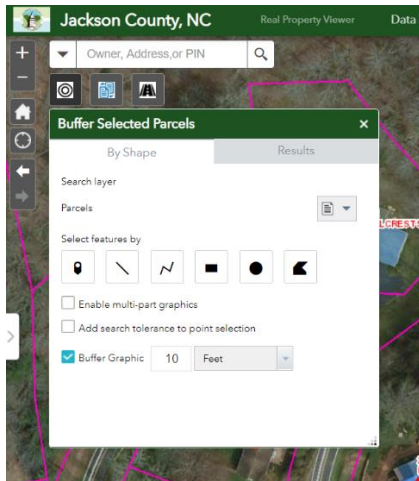

The Buffer Selected Parcels tool allows the user to create a buffer using point, line, or polygon, and get results of features within that buffer. To buffer a specific property, leave the box next to "Buffer Graphic" checked, choose the appropriate distance, then select the property on the map. If the box is left unchecked, it will allow the user to select specific parcels. More than one parcel can be selected by selecting the "Add to Current Results" from the drop-down menu to the right of Parcels. All other shapes will select properties which fall within the drawn area. Select the buffer distance before placing the point, line, or polygon.

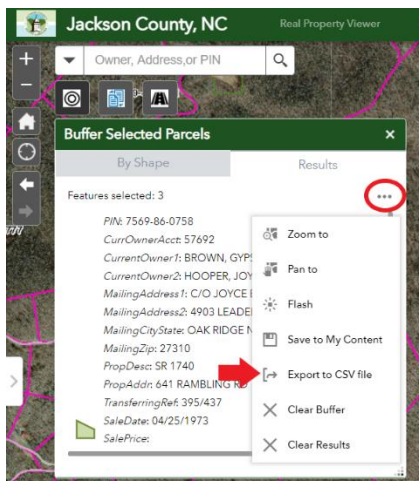

The selected data from the buffer can be exported as a CSV file. To export, click on the three dots in the results panel, and select Export to CSV file. This downloads a file on the user's computer. Closing the buffer tool will remove the buffer.

## Export to CAD

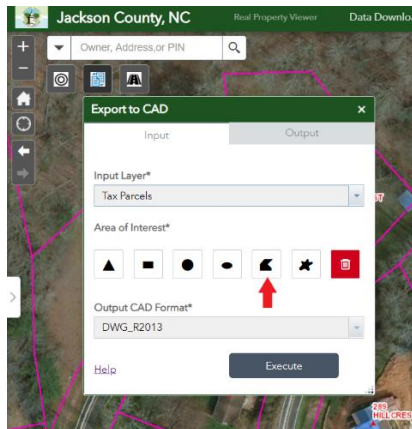

The Export to CAD tool allows the user to export map data to a selected CAD file format. The user can choose which input layer is to be exported, then choose from a variety of polygons to select the area of interest. To select the area of interest, choose a polygon, and then begin drawing on the map. For the polygon shown in the image above, the user must double click to end the drawing. Click on the given output to download the zipped CAD folder. The output will remain as long as the page is not reloaded, or a new output is created.

## Aerials



The Aerials button enables the user to select current and historic aerials to use as a base map. Aerial photography is flown by the State of North Carolina in a four-year cycle.

## Layer List

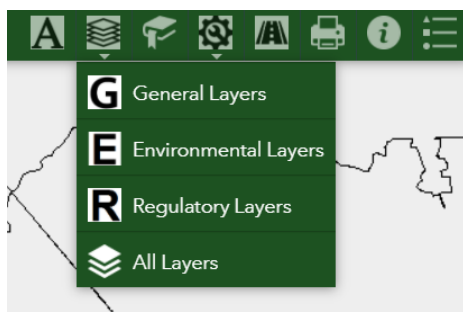

The Layer List gives you a list of active and inactive layers within the web map. Select from one of the categories, or select All Layers to look at all the layers available to view in the map. To activate a layer on the map, click the check box to the left of the layer name.

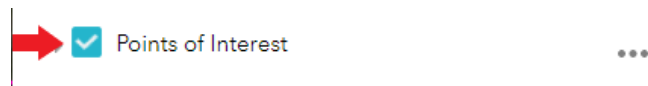

For further actions, click the three dots to the right of the layer.

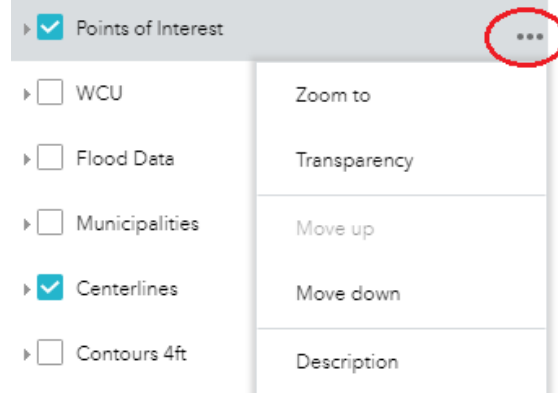

## **Legend**



The Legend button displays the symbols for the active layers on the map.

## **Bookmarks**



The Bookmark button allows the user to click on a bookmark that will zoom to a predetermined location on the map.

## **Print**



The Print button generates a PDF map of what is currently onscreen in the viewer. The user must give the map a title and choose a layout. There are several paper size and orientation options under the Layout drop down menu. The default layouts will create a map with preset Jackson County map elements. To print a map without these elements, choose the "Map Only" options. To Change the print quality, click the "Advanced" button. You may also print to other formats such as .jpg.

## **Utilities**



The Utilities button opens a list of tools that can be used on the map. Below are descriptions of each tool.

## **Property Query**

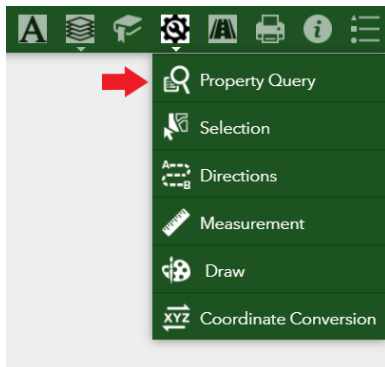

The Property Query tool allows the user to filter records by specific criteria. The query will locate any properties which contain any of the information entered into the query. For example, the user could find all properties sold by a specific owner in 2018 by typing in the owner name under the CurrentOwner1 tab and selecting a sale date between January 1, 2018 and the "today" option. The user does NOT have to have information entered into all the blanks, just the fields that are of interest. It is recommended that you do not search for queries with extremely large results as this can cause performance issues.

# Select

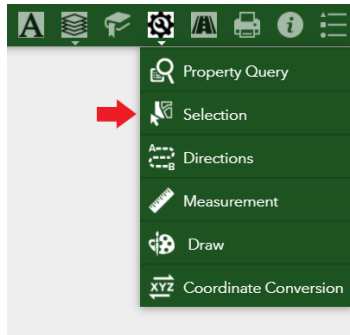

The Select tool allows the user to select specific features in a layer. To select a feature, the layer must first be activated. Be sure the Select button is dark green before drawing on the map. If the button is light green, it will only identify features instead of selecting them. The user can select multiple features by holding down shift, then clicking or drawing on the map. The user can also remove multiple features by holding down ctrl, then clicking or drawing on the map. To clear all selected features, click the Clear button.

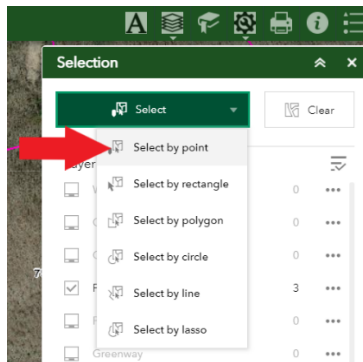

*Point Selection*

Using the point selection will only select one feature at a time. All other shapes will select properties which fall within the drawn area. To select multiple properties, draw a graphic around the properties you want to select.

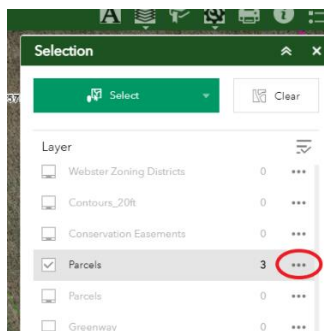

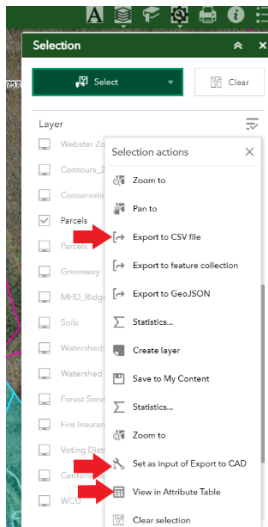

*Selection Options*

Clicking the three dots to the right allow the user to export the selected features as a CSV, set the selection as the input to the Export to CAD tool, or view in attribute table.

TransferringRef	SaleDate	SalePrice	PlatRef	Township	NbrhdCode	NbrhdName	FireDist	TotBldgValue	TotLandValue	TaxableValue	AssessedAcres	Prc_Url	OID
IG 2224/735	10/10/2018			05	CANEY FORK	05000	CANEY FORK	275,380.00	389,010.00		96.00	https://gis.jackson...	
IG 395/437	4/25/1973		22/215	05	CANEY FORK	05000	CULLOWHEE S MI	24,850.00	24,850.00	248,500.00	54.16	https://gis.jackson...	

*Attribute Table*

Township	NbrhdCode	NbrhdName	FireDist	TotBldgValue
CANEY FORK	05000	CANEY FORK	CULLOWHEE S MI	275,380.00

*Attribute Table Statistics*

When viewing the attribute table, the selected layers show up as blue. Click the statistics button to view statistics, such as, sum, average, and standard deviation. Statistics can only be calculated for columns containing integers. For example, the column labeled TotLandValue can sum up the total amount of the land value, but the field labeled NbrhdCode cannot sum up the numbers in that column. To close the attribute table, click the arrow above it. The arrow remains at the bottom of the map to pull the attribute table up at any time. Selected features can also be cleared by clicking the "Clear selection" button in the attribute table.

## Directions

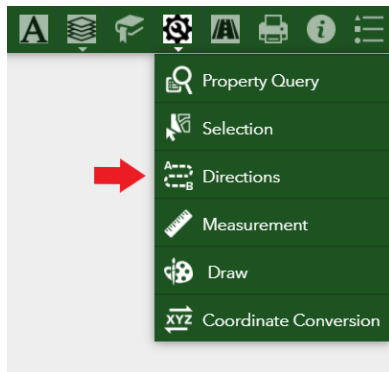

The Directions tool provides the user with driving directions to anywhere within Jackson County by either entering an address or clicking a location on the map. When entering an address, do NOT enter the town name, only enter the street name and number. Known barriers can be drawn onto the map. Drawing barriers on the map will reroute the user around that barrier. To remove a barrier, make sure the barrier button is selected and click on the existing barrier.

## Measurement

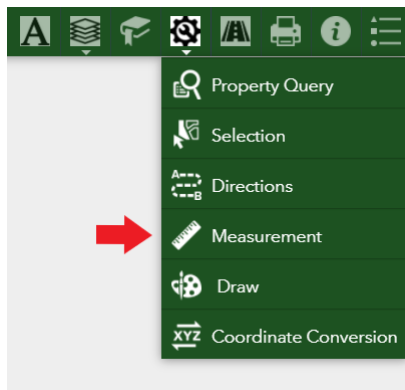

The Measurement tool gives the user the ability to measure distances on the map. Choose to measure by area, distance or location. The user can also select the measurement units, feet, miles, kilometers, etc.



## Draw

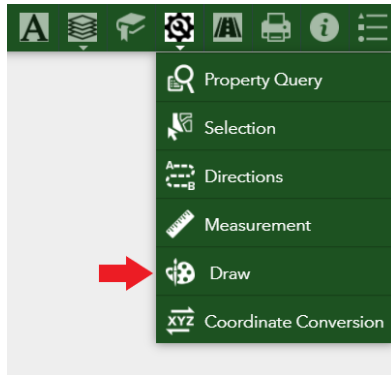

The draw tool enables the user to draw elements or text labels on the map. These elements will show up when the user uses the print widget, but will clear when the map is closed. Once the user begins drawing, the style of the drawing cannot be changed. Be sure to set styling options before drawing on the map. To see the length, or area of a drawn feature click the Show length measurement button. From there the user can select the unit type, font color, and font size. The button must be clicked and settings set before the user begins drawing on the map. Like the drawing these settings cannot be changed once the drawing is placed on the map, so the user must set the settings before they begin drawing on the map.

## Coordinate Conversion

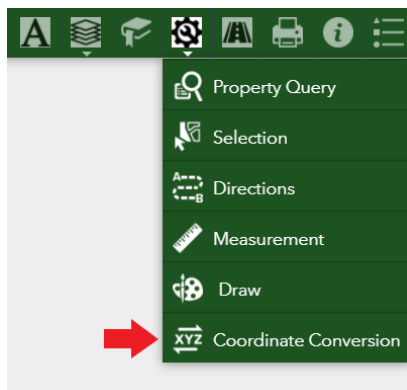

The coordinate conversion tool takes an entered coordinate or a point clicked on the map and provides conversions from different coordinate systems.