

DOWNS, JOSHUA A
 COAN, ALLYSON M
 1280 LATHAM ST
 BIRMINGHAM, MI 48009-3062
 ACCOUNT NUMBER: 193662

Jackson County, North Carolina

Parcel: 7653134101
 Tax Year: 2026
 Reval Year: 2025
 Appraised By: KEB on 10/28/2025
 Information Source: E - Estimate

Tax Districts
 General County Tax

PARCEL INFORMATION	PROPERTY DESCRIPTION	VALUE SUMMARY																				
Address: 1807 FISHER CREEK RD Neighborhood: 27004 - Fisher Creek Road Type: PS - Paved State Township: 27 - SYLVA RURAL Utilities: S-1, W-1 View:	FISHER CREEK RD 0.6200 AC <table border="1" style="width: 100%; border-collapse: collapse; margin-top: 5px;"> <thead> <tr style="background-color: #e1eef6;"> <th colspan="4">PERMIT INFORMATION</th> </tr> <tr> <th style="width: 10%;">Code</th> <th style="width: 15%;">Date</th> <th style="width: 35%;">Permit #</th> <th style="width: 40%;">Amount</th> </tr> </thead> <tbody> <tr> <td>SF</td> <td>8/19/2024</td> <td>27303-2-26216</td> <td>\$500,000</td> </tr> </tbody> </table>	PERMIT INFORMATION				Code	Date	Permit #	Amount	SF	8/19/2024	27303-2-26216	\$500,000	LAND: 34,300 BUILDING: 426,780 OBXF: 0 MARKET VALUE: 461,080 DEFERRED AMOUNT: 0 EXEMPT VALUE: 0 NET TAXABLE: 461,080								
PERMIT INFORMATION																						
Code	Date	Permit #	Amount																			
SF	8/19/2024	27303-2-26216	\$500,000																			
NOTES	SALES INFORMATION																					
	<table border="1" style="width: 100%; border-collapse: collapse;"> <thead> <tr style="background-color: #e1eef6;"> <th>Date</th> <th>Sales Price</th> <th>Valid</th> <th>Book/Page</th> </tr> </thead> <tbody> <tr> <td>6/15/2023</td> <td>340,000</td> <td>IR</td> <td>2357/1961</td> </tr> <tr> <td>6/19/2003</td> <td>140,000</td> <td>N</td> <td>1188/785</td> </tr> <tr> <td>2/16/1996</td> <td>38,000</td> <td>N</td> <td>912/489</td> </tr> <tr> <td>5/26/1989</td> <td>66,000</td> <td>N</td> <td>722/450</td> </tr> </tbody> </table> Plat Book: 00 Plat Card: 000	Date	Sales Price	Valid	Book/Page	6/15/2023	340,000	IR	2357/1961	6/19/2003	140,000	N	1188/785	2/16/1996	38,000	N	912/489	5/26/1989	66,000	N	722/450	
Date	Sales Price	Valid	Book/Page																			
6/15/2023	340,000	IR	2357/1961																			
6/19/2003	140,000	N	1188/785																			
2/16/1996	38,000	N	912/489																			
5/26/1989	66,000	N	722/450																			

LAND DATA - MARKET VALUE												
MTH	CODE	DESCRIPTION	ZONING	PRICE PER ACRE	ACRES	ADJ 1	ADJ 2	ADJ 3	UTILITIES	VALUE	NOTES	
1	A	0110 Residential		55,323	0.620				10,000	34,300		
Total Acres:					0.620	Total Land Value:				34,300		

OUTBUILDING DATA															
CODE	DESC	CT	LN	WD	UNITS	GRADE	AYB	EYB	COND	PHYS	FUNC	ECON	% CMPLT	TAX VALUE	NOTES

BUILDING DESCRIPTION	
VALUATION METHOD:	R - Residential
USE CODE:	R01 - SINGLE FAM DWLG
STYLE:	
FOUNDATION:	C - Continuous Wall
EXTERIOR WALL 1:	CP - Conc Board
EXTERIOR WALL 2:	
ROOF STRUCTURE:	S - Shed
ROOF COVER:	AS - Asphalt Shingle
BEDROOMS:	3
FULL BATHS:	3
HALF BATHS:	
GENERATOR:	N
FIREPLACE TYPE/CNT/OPN/CH:	SD/1/1/0
ELEVATOR COUNT:	
PHYS OVERRIDE:	
ECONOMIC DEPRECIATION:	
FUNCTIONAL DEPRECIATION:	
SPECIAL CONDITION CODE:	
SPECIAL CONDITION VALUE:	
DESCRIPTION:	
REMARKS:	
CARD NOTES:	
UNITS:	
HEATED SQUARE FEET:	1,124

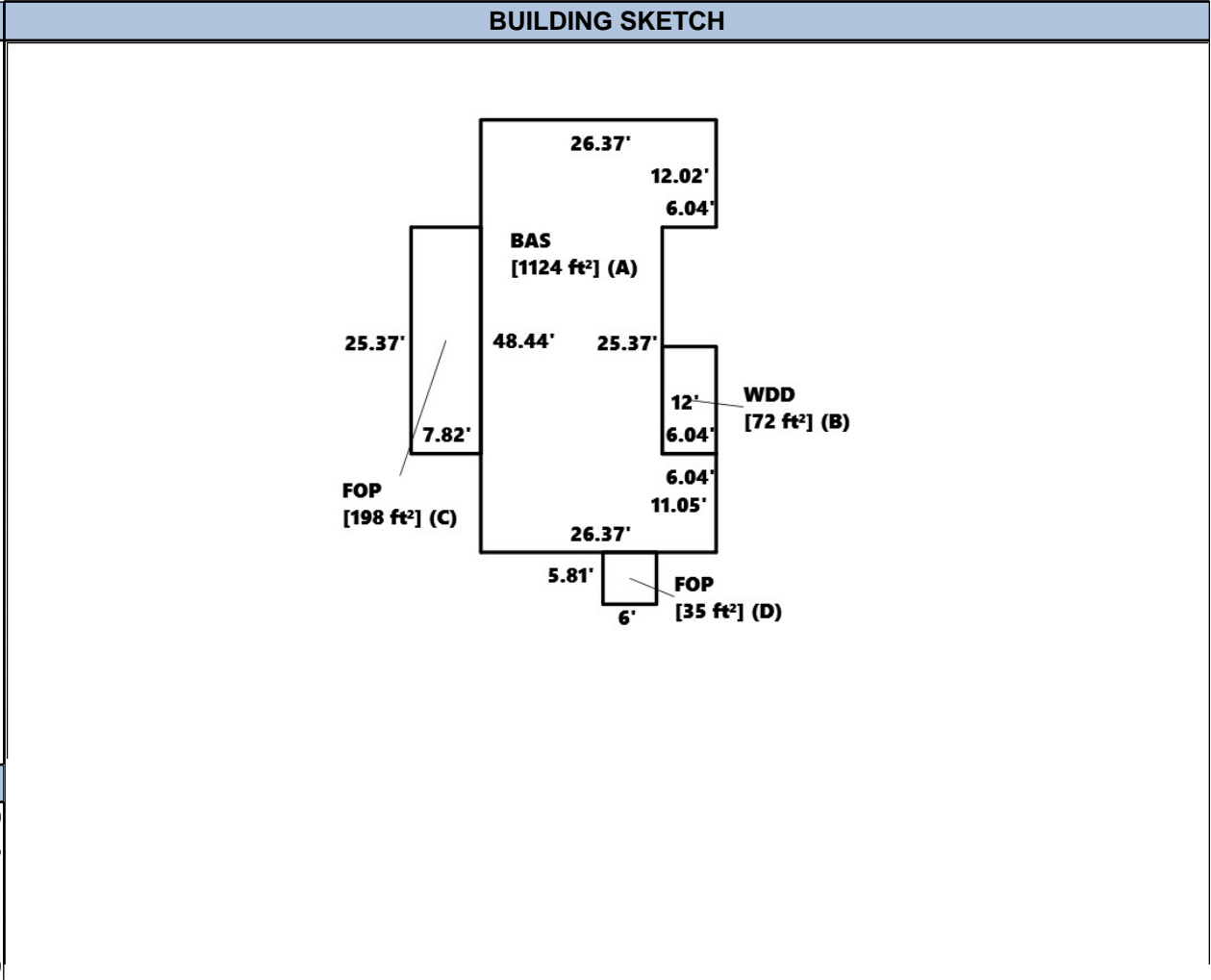

BUILDING COMPUTATION	
REPLACEMENT COST NEW	426,780
PHYSICAL DEPRECIATION	0%
FUNCTIONAL DEPRECIATION	
ECONOMIC DEPRECIATION	
% COMPLETE	
REPLACEMENT COST NEW LESS DEPRECIATION	426,780

BUILDING SECTION DETAIL																
TYPE	AREA	WALL HT	#ST	HEAT TYPE	HEAT%	AIR%	SPK%	GRADE	AYB	EYB	COND	P%	E%	F%	VALUE	
BAS	1124	9.00	1.0	HP		100%		C+	2024	2024	A	100%			311,870	
FOP	198		1.0									100%			14,670	
FOP	35		1.0									100%			2,590	
LLF	824		1.0									100%			87,570	
LLU	300		1.0									100%			7,410	
WDD	72		1.0									100%			2,670	