

PARKER, ROBERT HOMER  
 393 CARVER MOUNTAIN VLY  
 SYLVA, NC 28779-8563  
 ACCOUNT NUMBER: 30349

## Jackson County, North Carolina

Parcel: 7652601917

Tax Year: 2025

Reval Year: 2025

Appraised By: JEM on 09/19/2024

Information Source: E - Estimate

**Tax Districts**  
 General County Tax

PARCEL INFORMATION	PROPERTY DESCRIPTION	VALUE SUMMARY												
<b>Address:</b> 393 CARVER MOUNTAIN VLY <b>Neighborhood:</b> 27011 - Cope Creek <b>Road Type:</b> RG - Gravel Private <b>Township:</b> 27 - SYLVA RURAL <b>Utilities:</b> S-1, W-1 <b>View:</b>	OFF COPE CREEK RD 19.8000 AC <table border="1" style="width: 100%; border-collapse: collapse; margin-top: 5px;"> <thead> <tr style="background-color: #e1eef6;"> <th colspan="4">PERMIT INFORMATION</th> </tr> <tr style="background-color: #e1eef6;"> <th>Code</th> <th>Date</th> <th>Permit #</th> <th>Amount</th> </tr> </thead> <tbody> <tr> <td>HP</td> <td>7/15/2024</td> <td>23974-2-25923</td> <td></td> </tr> </tbody> </table>	PERMIT INFORMATION				Code	Date	Permit #	Amount	HP	7/15/2024	23974-2-25923		<b>LAND:</b> 276,590 <b>BUILDING:</b> 411,629 <b>OBXF:</b> 27,500 <b>MARKET VALUE:</b> 715,719 <b>DEFERRED AMOUNT:</b> 0 <b>EXEMPT VALUE:</b> 0 <b>NET TAXABLE:</b> 715,719
PERMIT INFORMATION														
Code	Date	Permit #	Amount											
HP	7/15/2024	23974-2-25923												
NOTES	SALES INFORMATION													
OB-NV	<table border="1" style="width: 100%; border-collapse: collapse;"> <thead> <tr style="background-color: #e1eef6;"> <th>Date</th> <th>Sales Price</th> <th>Valid</th> <th>Book/Page</th> </tr> </thead> <tbody> <tr> <td>8/15/1988</td> <td></td> <td>N</td> <td>700/523</td> </tr> </tbody> </table> <p>Plat Book: 00      Plat Card: 000</p>	Date	Sales Price	Valid	Book/Page	8/15/1988		N	700/523					
Date	Sales Price	Valid	Book/Page											
8/15/1988		N	700/523											

### LAND DATA - MARKET VALUE

MTH	CODE	DESCRIPTION	ZONING	PRICE PER ACRE	ACRES	ADJ 1	ADJ 2	ADJ 3	UTILITIES	VALUE	NOTES
1	A	0110 Residential		13,969	19.800	T-40			10,000	276,590	

**Total Acres: 19.800      Total Land Value: 276,590**

### OUTBUILDING DATA

CODE	DESC	CT	LN	WD	UNITS	GRADE	AYB	EYB	COND	PHYS	FUNC	ECON	% CMLPT	TAX VALUE	NOTES
26	GARAGE, UNFINISHED		30	24	720	C	1991	1991	A	0.49				27500	

BUILDING DESCRIPTION	
VALUATION METHOD:	R - Residential
USE CODE:	R01 - SINGLE FAM DWLG
STYLE:	
FOUNDATION:	C - Continuous Wall
EXTERIOR WALL 1:	LG - Log
EXTERIOR WALL 2:	
ROOF STRUCTURE:	G - Gable
ROOF COVER:	AS - Asphalt Shingle
BEDROOMS:	3
FULL BATHS:	2
HALF BATHS:	0
GENERATOR:	N
FIREPLACE TYPE/CNT/OPN/CH:	ST/1/1/1
ELEVATOR COUNT:	
PHYS OVERRIDE:	
ECONOMIC DEPRECIATION:	
FUNCTIONAL DEPRECIATION:	
SPECIAL CONDITION CODE:	
SPECIAL CONDITION VALUE:	
DESCRIPTION:	
REMARKS:	
CARD NOTES:	
UNITS:	
HEATED SQUARE FEET:	2,076

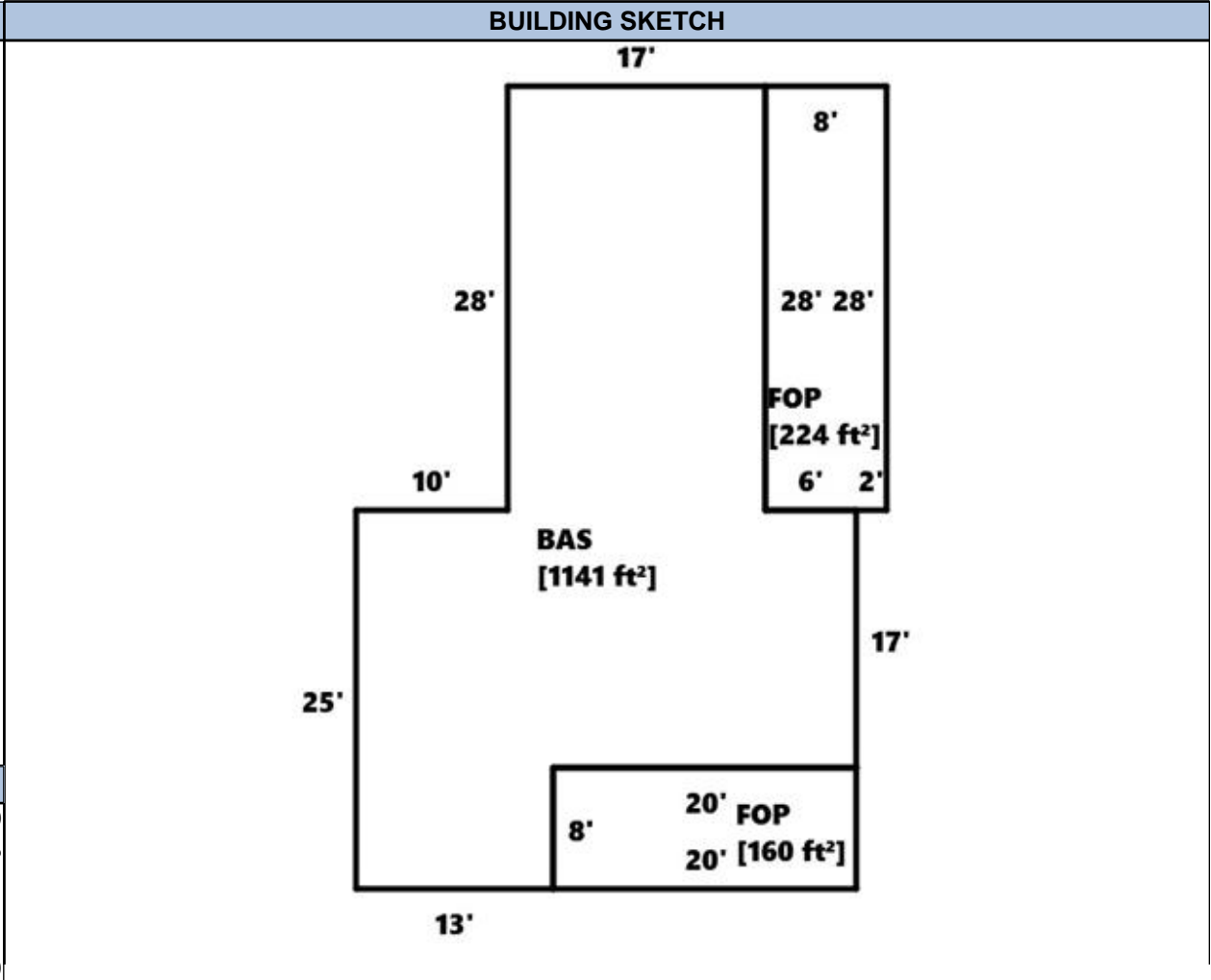

BUILDING COMPUTATION	
REPLACEMENT COST NEW	614,370
PHYSICAL DEPRECIATION	33%
FUNCTIONAL DEPRECIATION	
ECONOMIC DEPRECIATION	
% COMPLETE	
REPLACEMENT COST NEW LESS DEPRECIATION	411,629

BUILDING SECTION DETAIL																
TYPE	AREA	WALL HT	#ST	HEAT TYPE	HEAT%	AIR%	SPK%	GRADE	AYB	EYB	COND	P%	E%	F%	VALUE	
BAS	1141	8.00	1.5	HP		100%		C+	1979	1994	A	67%			227,519	
FOP	160		1.0									67%			7,906	
FOP	224		1.0									67%			11,062	
FUS	935		1.0									67%			146,355	
LLU	1141		1.0									67%			18,787	