

JONES, ANNE MARIE
 JONES, STEPHEN L
 605 CHUNNS COVE RD
 ASHEVILLE, NC 28805-1006
 ACCOUNT NUMBER: 117682

Jackson County, North Carolina

Parcel: 7642951250

Tax Year: 2025

Reval Year: 2025

Appraised By: LKF on 10/25/2023

Information Source: E - E

Tax Districts
 General County Tax

PARCEL INFORMATION	PROPERTY DESCRIPTION	VALUE SUMMARY																				
Address: 53 DEWEES DR Neighborhood: 27004 - Fisher Creek Road Type: PS - Paved State Township: 27 - SYLVA RURAL Utilities: W-1, S-1 View:	FISHER CREEK 3.0100 AC <table border="1" style="width: 100%; border-collapse: collapse; margin-top: 5px;"> <thead> <tr style="background-color: #e1eef6;"> <th colspan="4">PERMIT INFORMATION</th> </tr> <tr style="background-color: #e1eef6;"> <th>Code</th> <th>Date</th> <th>Permit #</th> <th>Amount</th> </tr> </thead> <tbody> <tr><td> </td><td> </td><td> </td><td> </td></tr> <tr><td> </td><td> </td><td> </td><td> </td></tr> <tr><td> </td><td> </td><td> </td><td> </td></tr> </tbody> </table>	PERMIT INFORMATION				Code	Date	Permit #	Amount													LAND: 78,390 BUILDING: 411,785 OBXF: 0 MARKET VALUE: 490,175 DEFERRED AMOUNT: 0 EXEMPT VALUE: 0 NET TAXABLE: 490,175
PERMIT INFORMATION																						
Code	Date	Permit #	Amount																			
NOTES	SALES INFORMATION																					
	<table border="1" style="width: 100%; border-collapse: collapse;"> <thead> <tr style="background-color: #e1eef6;"> <th>Date</th> <th>Sales Price</th> <th>Valid</th> <th>Book/Page</th> </tr> </thead> <tbody> <tr><td>1/9/2018</td><td></td><td>C</td><td>2205/564</td></tr> <tr><td>8/31/2009</td><td></td><td>C</td><td>1817/555</td></tr> <tr><td>5/28/2003</td><td></td><td>N</td><td>1186/766</td></tr> <tr><td>4/28/1994</td><td></td><td>N</td><td>856/500</td></tr> </tbody> </table> Plat Book: Plat Card:	Date	Sales Price	Valid	Book/Page	1/9/2018		C	2205/564	8/31/2009		C	1817/555	5/28/2003		N	1186/766	4/28/1994		N	856/500	
Date	Sales Price	Valid	Book/Page																			
1/9/2018		C	2205/564																			
8/31/2009		C	1817/555																			
5/28/2003		N	1186/766																			
4/28/1994		N	856/500																			

LAND DATA - MARKET VALUE												
MTH	CODE	DESCRIPTION	ZONING	PRICE PER ACRE	ACRES	ADJ 1	ADJ 2	ADJ 3	UTILITIES	VALUE	NOTES	
1	A	0110 Residential		26,043	3.010				10,000	78,390		
Total Acres:					3.010	Total Land Value:				78,390		

OUTBUILDING DATA															
CODE	DESC	CT	LN	WD	UNITS	GRADE	AYB	EYB	COND	PHYS	FUNC	ECON	% CMPLT	TAX VALUE	NOTES

BUILDING DESCRIPTION	
VALUATION METHOD:	R - Residential
USE CODE:	R01 - SINGLE FAM DWLG
STYLE:	
FOUNDATION:	C - Continuous Wall
EXTERIOR WALL 1:	BR - Brick
EXTERIOR WALL 2:	
ROOF STRUCTURE:	G - Gable
ROOF COVER:	AS - Asphalt Shingle
BEDROOMS:	3
FULL BATHS:	2
HALF BATHS:	1
GENERATOR:	N
FIREPLACE TYPE/CNT/OPN/CH:	SD/1/1/1
ELEVATOR COUNT:	
PHYS OVERRIDE:	
ECONOMIC DEPRECIATION:	
FUNCTIONAL DEPRECIATION:	
SPECIAL CONDITION CODE:	
SPECIAL CONDITION VALUE:	
DESCRIPTION:	
REMARKS:	
CARD NOTES:	
UNITS:	
HEATED SQUARE FEET:	2,500

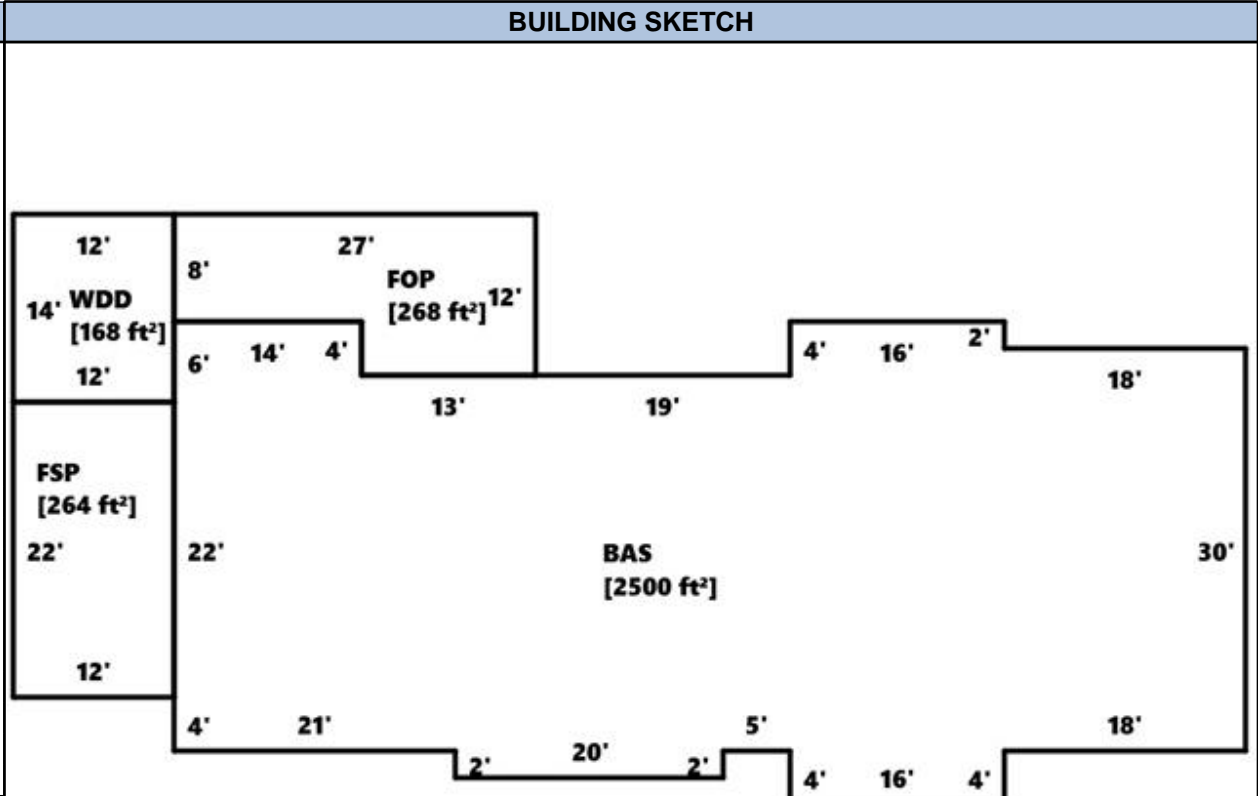

BUILDING COMPUTATION	
REPLACEMENT COST NEW	776,950
PHYSICAL DEPRECIATION	47%
FUNCTIONAL DEPRECIATION	
ECONOMIC DEPRECIATION	
% COMPLETE	
REPLACEMENT COST NEW LESS DEPRECIATION	411,785

BUILDING SECTION DETAIL																
TYPE	AREA	WALL HT	#ST	HEAT TYPE	HEAT%	AIR%	SPK%	GRADE	AYB	EYB	COND	P%	E%	F%	VALUE	
BAS	2500	8.00	1.0	HP		100%		B	1955	1985	A	53%			355,021	
FOP	268		1.0									53%			9,895	
FSP	264		1.0									53%			12,996	
LLU	2500		1.0									53%			30,772	
WDD	168		1.0									53%			3,101	