

POLYASKO, KAREN L KAPELKA
 180 PAW PAW CV
 SYLVA, NC 28779
 ACCOUNT NUMBER: 180499

Jackson County, North Carolina

Parcel: 7640049412

Tax Year: 2025

Reval Year: 2025

Appraised By: LKF on 05/29/2024

Information Source: E - E

Tax Districts
 General County Tax

PARCEL INFORMATION	PROPERTY DESCRIPTION	VALUE SUMMARY																				
Address: 180 PAW PAW CV Neighborhood: 29017 - Paw Paw Cove Road Type: RP - Paved Private Township: 29 - WEBSTER Utilities: S-1, PW-1 View:	LT 3 PAW PAW COVE 0.7400 AC <table border="1" style="width: 100%; border-collapse: collapse; margin-top: 5px;"> <thead> <tr style="background-color: #e1eef6;"> <th colspan="4">PERMIT INFORMATION</th> </tr> <tr style="background-color: #e1eef6;"> <th>Code</th> <th>Date</th> <th>Permit #</th> <th>Amount</th> </tr> </thead> <tbody> <tr><td> </td><td> </td><td> </td><td> </td></tr> <tr><td> </td><td> </td><td> </td><td> </td></tr> <tr><td> </td><td> </td><td> </td><td> </td></tr> </tbody> </table>	PERMIT INFORMATION				Code	Date	Permit #	Amount													LAND: 35,470 BUILDING: 448,915 OBXF: 0 MARKET VALUE: 484,385 DEFERRED AMOUNT: 0 EXEMPT VALUE: 0 NET TAXABLE: 484,385
PERMIT INFORMATION																						
Code	Date	Permit #	Amount																			
NOTES	SALES INFORMATION																					
	<table border="1" style="width: 100%; border-collapse: collapse;"> <thead> <tr style="background-color: #e1eef6;"> <th>Date</th> <th>Sales Price</th> <th>Valid</th> <th>Book/Page</th> </tr> </thead> <tbody> <tr><td>5/18/2018</td><td></td><td>C</td><td>2214/555</td></tr> <tr><td>2/21/2018</td><td></td><td>C</td><td>16CVD/184</td></tr> <tr><td>3/15/2011</td><td>299,000</td><td>P</td><td>1888/91</td></tr> <tr><td>12/3/2010</td><td>314,000</td><td>P</td><td>1875/704</td></tr> </tbody> </table>	Date	Sales Price	Valid	Book/Page	5/18/2018		C	2214/555	2/21/2018		C	16CVD/184	3/15/2011	299,000	P	1888/91	12/3/2010	314,000	P	1875/704	
Date	Sales Price	Valid	Book/Page																			
5/18/2018		C	2214/555																			
2/21/2018		C	16CVD/184																			
3/15/2011	299,000	P	1888/91																			
12/3/2010	314,000	P	1875/704																			
	<table border="1" style="width: 100%; border-collapse: collapse;"> <tr> <td style="width: 50%;">Plat Book:</td> <td style="width: 50%;">Plat Card:</td> </tr> </table>	Plat Book:	Plat Card:																			
Plat Book:	Plat Card:																					

LAND DATA - MARKET VALUE												
MTH	CODE	DESCRIPTION	ZONING	PRICE PER ACRE	ACRES	ADJ 1	ADJ 2	ADJ 3	UTILITIES	VALUE	NOTES	
1	A	0110 Residential		47,932	0.740				4,000	35,470		
Total Acres:					0.740	Total Land Value:				35,470		

OUTBUILDING DATA															
CODE	DESC	CT	LN	WD	UNITS	GRADE	AYB	EYB	COND	PHYS	FUNC	ECON	% CMPLT	TAX VALUE	NOTES

BUILDING DESCRIPTION	
VALUATION METHOD:	R - Residential
USE CODE:	R01 - SINGLE FAM DWLG
STYLE:	
FOUNDATION:	C - Continuous Wall
EXTERIOR WALL 1:	FR - Frame
EXTERIOR WALL 2:	
ROOF STRUCTURE:	G - Gable
ROOF COVER:	AS - Asphalt Shingle
BEDROOMS:	3
FULL BATHS:	2
HALF BATHS:	
GENERATOR:	N
FIREPLACE TYPE/CNT/OPN/CH:	
ELEVATOR COUNT:	
PHYS OVERRIDE:	
ECONOMIC DEPRECIATION:	
FUNCTIONAL DEPRECIATION:	
SPECIAL CONDITION CODE:	
SPECIAL CONDITION VALUE:	
DESCRIPTION:	
REMARKS:	WDD & PTO SQ FOR SKETCH
CARD NOTES:	
UNITS:	
HEATED SQUARE FEET:	2,191

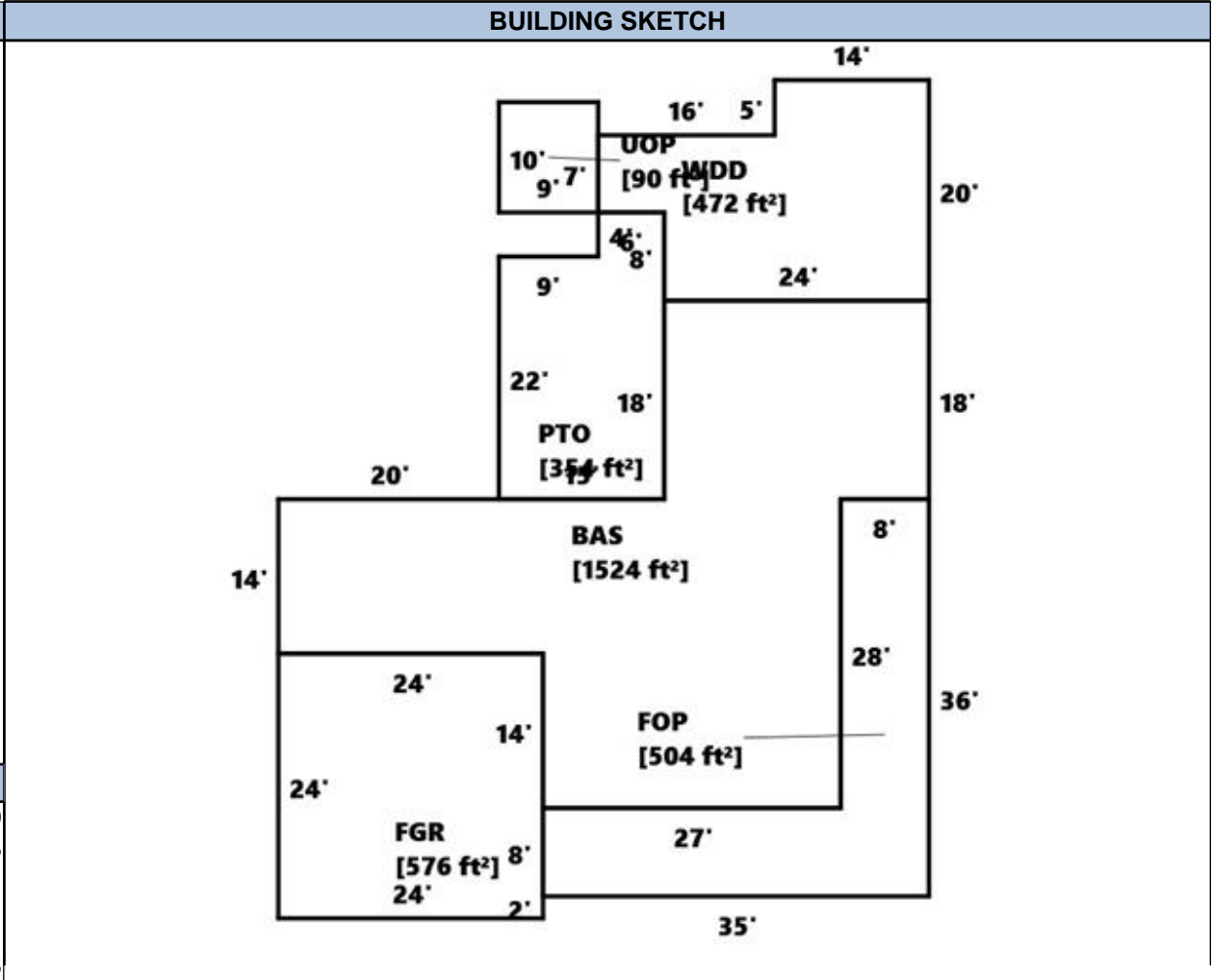

BUILDING COMPUTATION	
REPLACEMENT COST NEW	701,430
PHYSICAL DEPRECIATION	36%
FUNCTIONAL DEPRECIATION	
ECONOMIC DEPRECIATION	
% COMPLETE	
REPLACEMENT COST NEW LESS DEPRECIATION	448,915

BUILDING SECTION DETAIL																
TYPE	AREA	WALL HT	#ST	HEAT TYPE	HEAT%	AIR%	SPK%	GRADE	AYB	EYB	COND	P%	E%	F%	VALUE	
BAS	1524	8.00	1.0	HP		100%		C+	1992	1992	A	64%			259,251	
FGR	576		1.0									64%			45,946	
FOP	504		1.0									64%			24,122	
FUS	667		1.0									64%			101,894	
PTO	354		1.0									64%			2,822	
UOP	90		1.0									64%			3,590	
WDD	472		1.0									64%			11,290	