

CORNETTA, FRANK M JR
 PO BOX 1220
 WHITTIER, NC 28789-1220
 ACCOUNT NUMBER: 139186

Jackson County, North Carolina

Parcel: 7614508859

Tax Year: 2025

Reval Year: 2025

Appraised By: LKF on 03/27/2024

Information Source: O - Owner

Tax Districts
 General County Tax

PARCEL INFORMATION	PROPERTY DESCRIPTION	VALUE SUMMARY																				
Address: 80 SLOW LN Neighborhood: 19014 - Mountain View Est Road Type: RP - Paved Private Township: 19 - QUALLA Utilities: S-1, CW-1 View: SR - Short Range	LT 17 MOUNTAIN VIEW EST 1.4300 AC <table border="1" style="width: 100%; border-collapse: collapse; margin-top: 5px;"> <thead> <tr style="background-color: #e1eef6;"> <th colspan="4">PERMIT INFORMATION</th> </tr> <tr style="background-color: #e1eef6;"> <th>Code</th> <th>Date</th> <th>Permit #</th> <th>Amount</th> </tr> </thead> <tbody> <tr><td> </td><td> </td><td> </td><td> </td></tr> <tr><td> </td><td> </td><td> </td><td> </td></tr> <tr><td> </td><td> </td><td> </td><td> </td></tr> </tbody> </table>	PERMIT INFORMATION				Code	Date	Permit #	Amount													LAND: 55,890 BUILDING: 449,149 OBXF: 9,000 MARKET VALUE: 514,039 DEFERRED AMOUNT: 0 EXEMPT VALUE: 0 NET TAXABLE: 514,039
PERMIT INFORMATION																						
Code	Date	Permit #	Amount																			
NOTES	SALES INFORMATION																					
OUTBUILDING N/V	<table border="1" style="width: 100%; border-collapse: collapse;"> <thead> <tr style="background-color: #e1eef6;"> <th>Date</th> <th>Sales Price</th> <th>Valid</th> <th>Book/Page</th> </tr> </thead> <tbody> <tr><td>12/20/2006</td><td></td><td>NA</td><td>1640/849</td></tr> <tr><td>10/30/2006</td><td>46,500</td><td>NA</td><td>1627/562</td></tr> <tr><td>10/26/2006</td><td>42,500</td><td>NA</td><td>1626/730</td></tr> </tbody> </table>	Date	Sales Price	Valid	Book/Page	12/20/2006		NA	1640/849	10/30/2006	46,500	NA	1627/562	10/26/2006	42,500	NA	1626/730					
Date	Sales Price	Valid	Book/Page																			
12/20/2006		NA	1640/849																			
10/30/2006	46,500	NA	1627/562																			
10/26/2006	42,500	NA	1626/730																			
	<table border="1" style="width: 100%; border-collapse: collapse;"> <tr> <td style="width: 50%;">Plat Book:</td> <td style="width: 50%;">Plat Card:</td> </tr> </table>	Plat Book:	Plat Card:																			
Plat Book:	Plat Card:																					

LAND DATA - MARKET VALUE												
MTH	CODE	DESCRIPTION	ZONING	PRICE PER ACRE	ACRES	ADJ 1	ADJ 2	ADJ 3	UTILITIES	VALUE	NOTES	
1	A	0150 Res View		39,084	1.430	T-30			4,000	55,890		
Total Acres:					1.430	Total Land Value:				55,890		

OUTBUILDING DATA															
CODE	DESC	CT	LN	WD	UNITS	GRADE	AYB	EYB	COND	PHYS	FUNC	ECON	% CmplT	TAX VALUE	NOTES
16	CARPORT, AVG QUAL		18	12	216	C	2014	2014	A	0.82				9000	

BUILDING DESCRIPTION	
VALUATION METHOD:	R - Residential
USE CODE:	R01 - SINGLE FAM DWLG
STYLE:	
FOUNDATION:	C - Continuous Wall
EXTERIOR WALL 1:	LG - Log
EXTERIOR WALL 2:	FR - Frame
ROOF STRUCTURE:	G - Gable
ROOF COVER:	MT - Metal
BEDROOMS:	3
FULL BATHS:	2
HALF BATHS:	1
GENERATOR:	N
FIREPLACE TYPE/CNT/OPN/CH:	PF/1/3/2
ELEVATOR COUNT:	
PHYS OVERRIDE:	
ECONOMIC DEPRECIATION:	
FUNCTIONAL DEPRECIATION:	0.20
SPECIAL CONDITION CODE:	
SPECIAL CONDITION VALUE:	
DESCRIPTION:	
REMARKS:	
CARD NOTES:	
UNITS:	
HEATED SQUARE FEET:	1,636

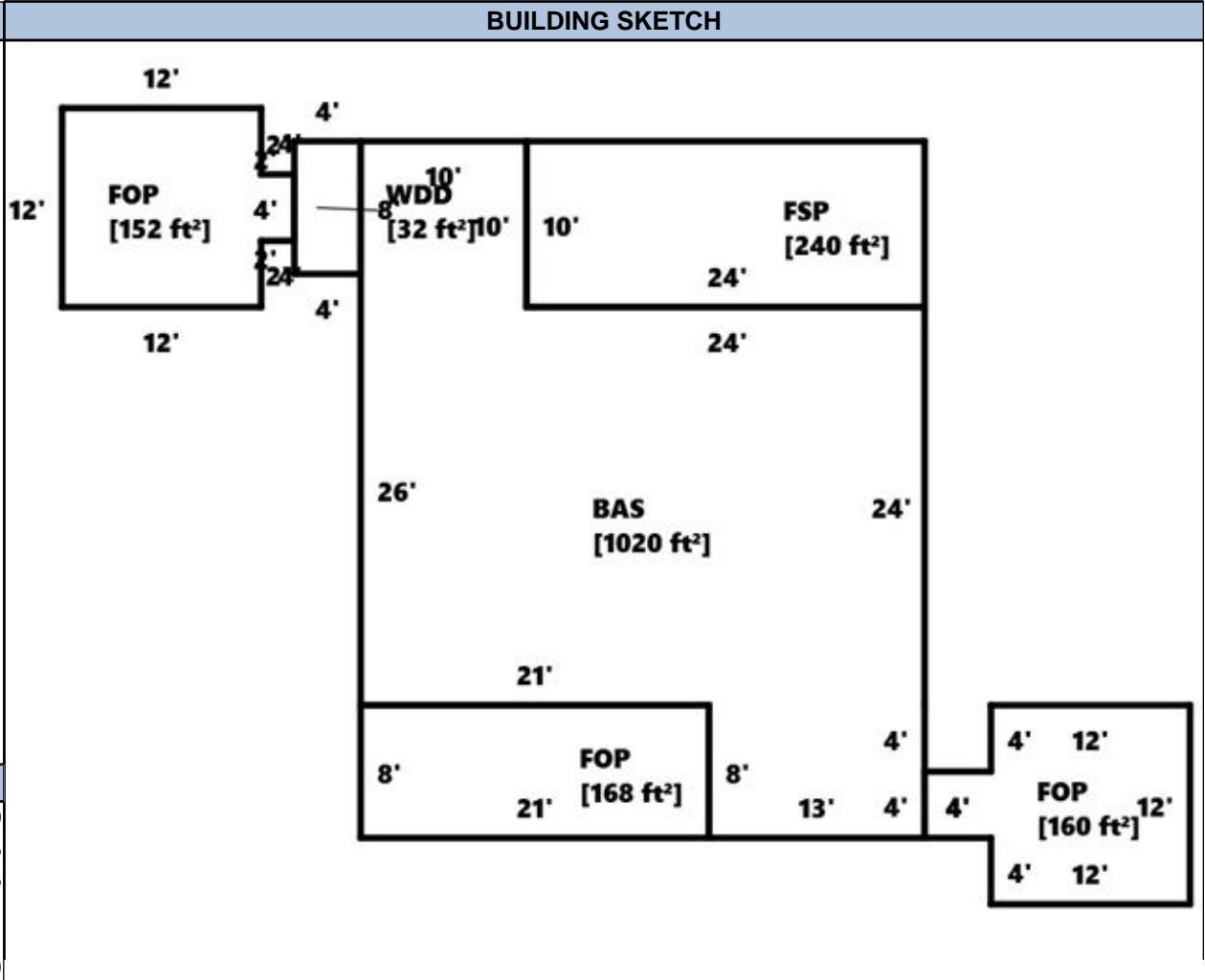

BUILDING COMPUTATION	
REPLACEMENT COST NEW	668,440
PHYSICAL DEPRECIATION	16%
FUNCTIONAL DEPRECIATION	20%
ECONOMIC DEPRECIATION	
% COMPLETE	
REPLACEMENT COST NEW LESS DEPRECIATION	449,149

BUILDING SECTION DETAIL															
TYPE	AREA	WALL HT	#ST	HEAT TYPE	HEAT%	AIR%	SPK%	GRADE	AYB	EYB	COND	P%	E%	F%	VALUE
BAS	1020	8.00	1.5	HP		100%		C+	2007	2007	A	84%			271,739
FOP	152		1.0									84%			9,805
FOP	160		1.0									84%			10,244
FOP	168		1.0									84%			10,782
FSP	240		1.0									84%			20,587
FUS	616		1.0									84%			125,007
WDD	32		1.0									84%			985