

WOLF, LINDA S
 WOLF, NIKOLAUS S
 192 IRIS LN
 WHITTIER, NC 28789
 ACCOUNT NUMBER: 191805

Jackson County, North Carolina

Parcel: 7613713239

Tax Year: 2025

Reval Year: 2025

Appraised By: LKF on 02/19/2024

Information Source: E - Estimate

Tax Districts
 General County Tax

PARCEL INFORMATION	PROPERTY DESCRIPTION	VALUE SUMMARY																				
Address: 192 IRIS LN Neighborhood: 01010 - Isis Cove Road Type: RG - Gravel Private Township: 19 - QUALLA Utilities: S-1, W-1 View:	LT 1 CROSS & SQUIBB 1.9600 AC <table border="1" style="width: 100%; border-collapse: collapse; margin-top: 5px;"> <thead> <tr style="background-color: #e1eef6;"> <th colspan="4">PERMIT INFORMATION</th> </tr> <tr style="background-color: #e1eef6;"> <th>Code</th> <th>Date</th> <th>Permit #</th> <th>Amount</th> </tr> </thead> <tbody> <tr><td> </td><td> </td><td> </td><td> </td></tr> <tr><td> </td><td> </td><td> </td><td> </td></tr> <tr><td> </td><td> </td><td> </td><td> </td></tr> </tbody> </table>	PERMIT INFORMATION				Code	Date	Permit #	Amount													LAND: 32,940 BUILDING: 533,555 OBXF: 27,700 MARKET VALUE: 594,195 DEFERRED AMOUNT: 0 EXEMPT VALUE: 0 NET TAXABLE: 594,195
PERMIT INFORMATION																						
Code	Date	Permit #	Amount																			
NOTES	SALES INFORMATION																					
	<table border="1" style="width: 100%; border-collapse: collapse;"> <thead> <tr style="background-color: #e1eef6;"> <th>Date</th> <th>Sales Price</th> <th>Valid</th> <th>Book/Page</th> </tr> </thead> <tbody> <tr> <td>8/11/2022</td> <td></td> <td>C</td> <td>2340/1756</td> </tr> <tr> <td>7/16/2004</td> <td>24,500</td> <td>N</td> <td>1436/153</td> </tr> </tbody> </table> <p>Plat Book: 00 Plat Card: 000</p>	Date	Sales Price	Valid	Book/Page	8/11/2022		C	2340/1756	7/16/2004	24,500	N	1436/153									
Date	Sales Price	Valid	Book/Page																			
8/11/2022		C	2340/1756																			
7/16/2004	24,500	N	1436/153																			

LAND DATA - MARKET VALUE												
MTH	CODE	DESCRIPTION	ZONING	PRICE PER ACRE	ACRES	ADJ 1	ADJ 2	ADJ 3	UTILITIES	VALUE	NOTES	
1	A	0110 Residential		16,806	1.960	T-40			10,000	32,940		
Total Acres:					1.960	Total Land Value:				32,940		

OUTBUILDING DATA															
CODE	DESC	CT	LN	WD	UNITS	GRADE	AYB	EYB	COND	PHYS	FUNC	ECON	% CMLPT	TAX VALUE	NOTES
10	CABIN, GOOD QUAL		24	10	240	C	2007	2007	A	0.78				19100	ENCHANTED CABIN
48	POOL, VINYL		7	16	112	C	2016	2016	A	0.58				8600	

BUILDING DESCRIPTION	
VALUATION METHOD:	R - Residential
USE CODE:	R01 - SINGLE FAM DWLG
STYLE:	
FOUNDATION:	C - Continuous Wall
EXTERIOR WALL 1:	CP - Conc Board
EXTERIOR WALL 2:	
ROOF STRUCTURE:	G - Gable
ROOF COVER:	AS - Asphalt Shingle
BEDROOMS:	3
FULL BATHS:	2
HALF BATHS:	
GENERATOR:	N
FIREPLACE TYPE/CNT/OPN/CH:	SD/1/1/1
ELEVATOR COUNT:	
PHYS OVERRIDE:	
ECONOMIC DEPRECIATION:	
FUNCTIONAL DEPRECIATION:	
SPECIAL CONDITION CODE:	
SPECIAL CONDITION VALUE:	
DESCRIPTION:	
REMARKS:	
CARD NOTES:	
UNITS:	
HEATED SQUARE FEET:	1,897

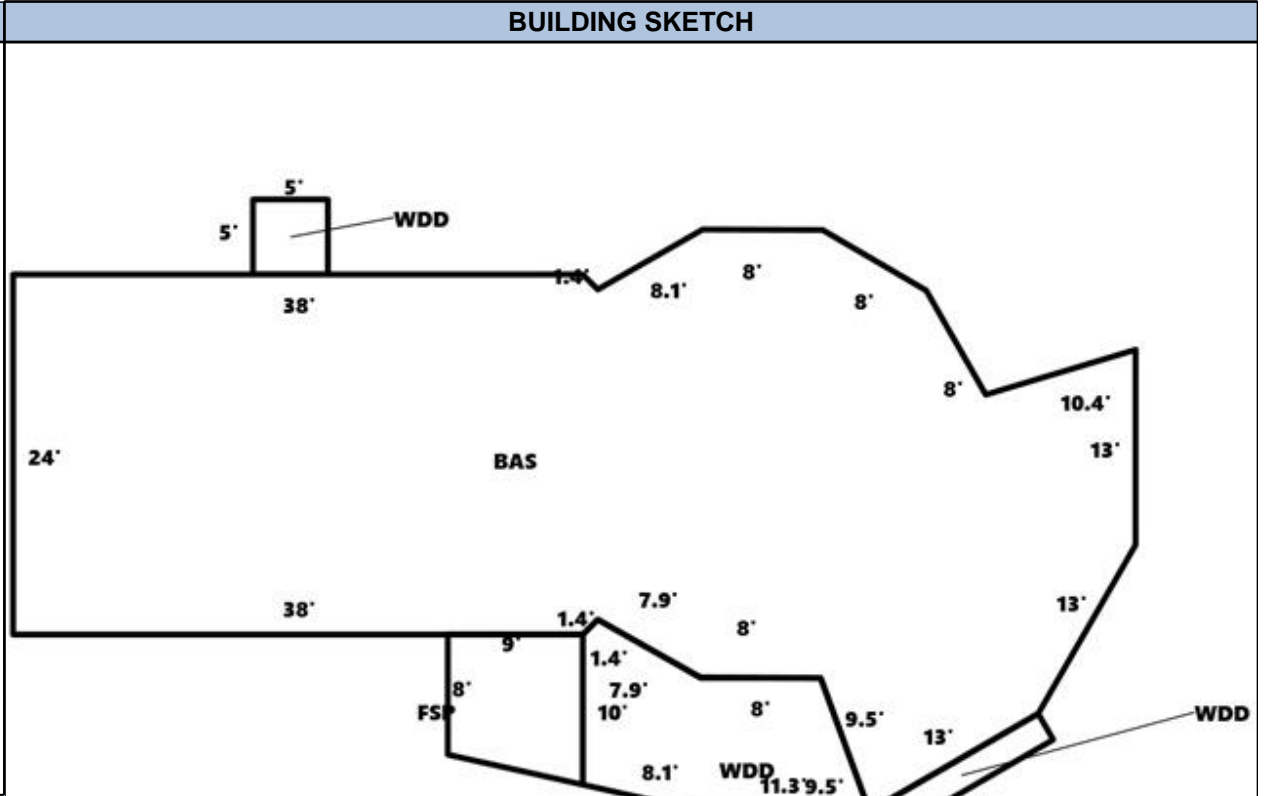

BUILDING COMPUTATION	
REPLACEMENT COST NEW	468,190
PHYSICAL DEPRECIATION	17%
FUNCTIONAL DEPRECIATION	
ECONOMIC DEPRECIATION	
% COMPLETE	
REPLACEMENT COST NEW LESS DEPRECIATION	388,596

BUILDING SECTION DETAIL																
TYPE	AREA	WALL HT	#ST	HEAT TYPE	HEAT%	AIR%	SPK%	GRADE	AYB	EYB	COND	P%	E%	F%	VALUE	
BAS	1897	8.00	1.0	HP		100%		C+	2006	2006	A	83%			368,279	
FSP	81		1.0									83%			5,793	
PTO	416		1.0									83%			3,718	
PTO	560		1.0									83%			5,005	
WDD	25		1.0									83%			672	
WDD	26		1.0									83%			697	
WDD	165		1.0									83%			4,432	

BUILDING DESCRIPTION	
VALUATION METHOD:	R - Residential
USE CODE:	R01 - SINGLE FAM DWLG
STYLE:	
FOUNDATION:	C - Continuous Wall
EXTERIOR WALL 1:	CP - Conc Board
EXTERIOR WALL 2:	
ROOF STRUCTURE:	G - Gable
ROOF COVER:	AS - Asphalt Shingle
BEDROOMS:	1
FULL BATHS:	1
HALF BATHS:	
GENERATOR:	N
FIREPLACE TYPE/CNT/OPN/CH:	
ELEVATOR COUNT:	
PHYS OVERRIDE:	
ECONOMIC DEPRECIATION:	
FUNCTIONAL DEPRECIATION:	
SPECIAL CONDITION CODE:	
SPECIAL CONDITION VALUE:	
DESCRIPTION:	
REMARKS:	
CARD NOTES:	
UNITS:	
HEATED SQUARE FEET:	454

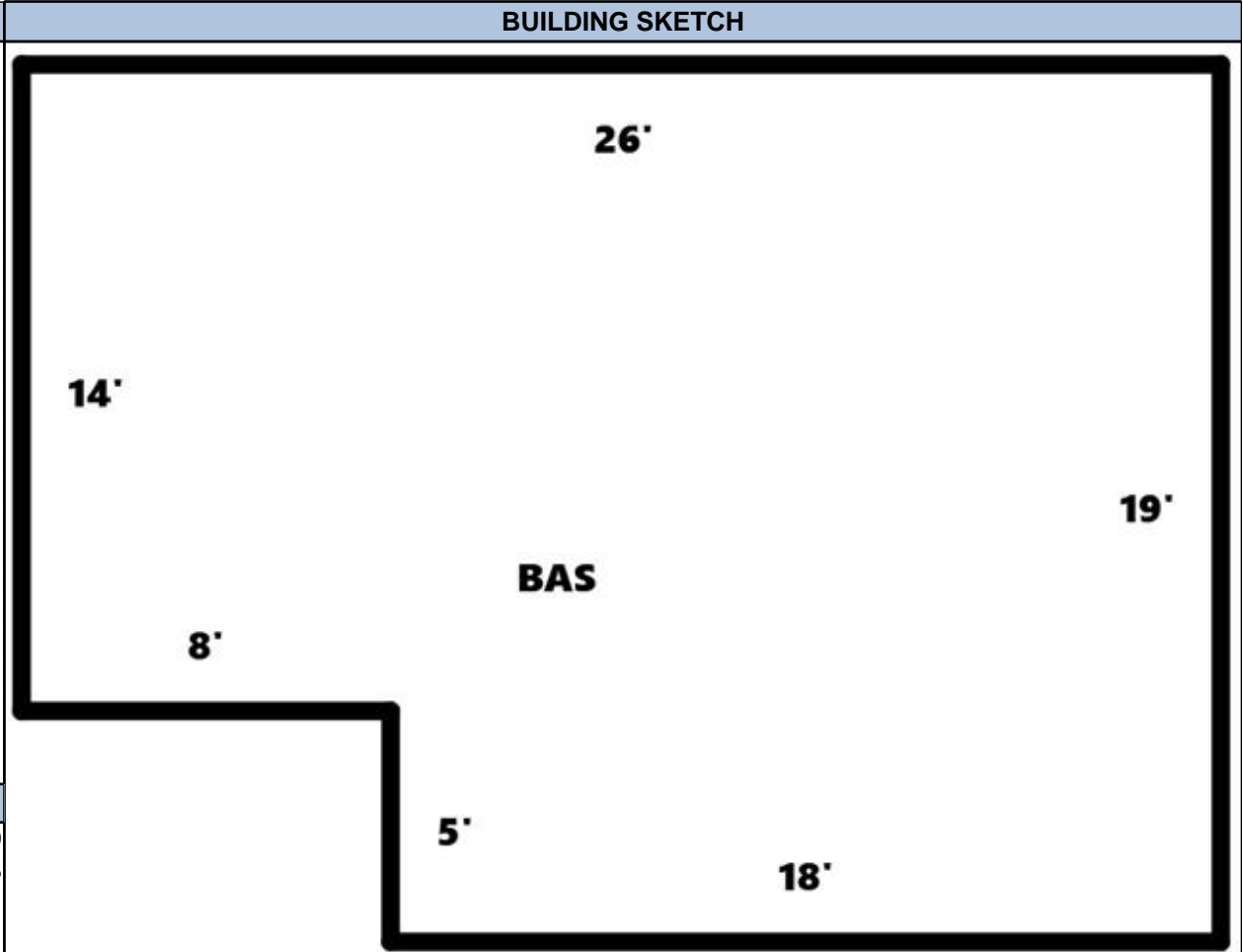

BUILDING COMPUTATION	
REPLACEMENT COST NEW	155,870
PHYSICAL DEPRECIATION	7%
FUNCTIONAL DEPRECIATION	
ECONOMIC DEPRECIATION	
% COMPLETE	
REPLACEMENT COST NEW LESS DEPRECIATION	144,959

BUILDING SECTION DETAIL															
TYPE	AREA	WALL HT	#ST	HEAT TYPE	HEAT%	AIR%	SPK%	GRADE	AYB	EYB	COND	P%	E%	F%	VALUE
BAS	454	8.00	1.0	HP		100%		C	2016	2016	A	93%			144,959